

Customer approval :

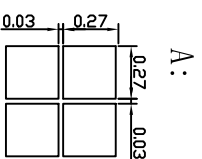
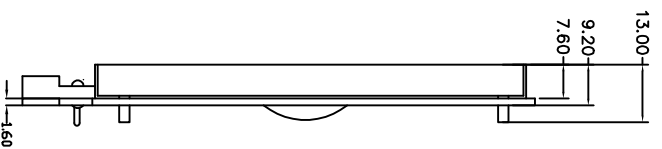
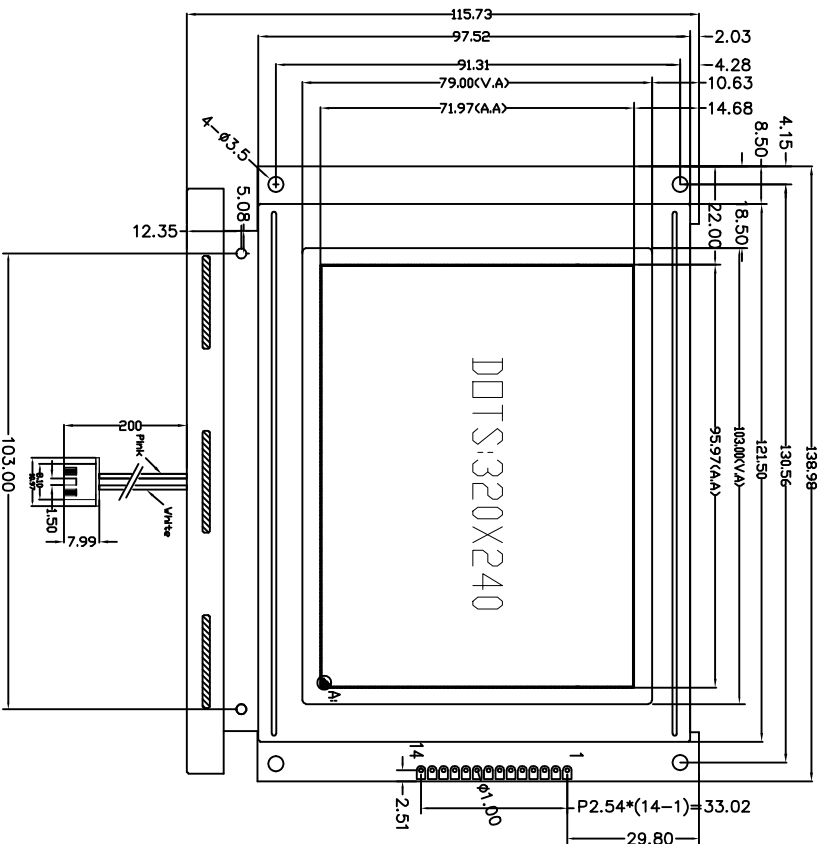

SPECIFICATION:

- 1). Driving: Duty:1/240, Bias:1/16, V0:-13.8V, VDD:5V
- 2). VIEWING DIRECTION: 6 O'CLOCK
- 3). Display mode: STN/Negative/Transmissive/Blue
- 4). Operating temp.: -20° C~+70° C
Storage temp.: -30° C~+80° C
- 5). Control IC: NC
- 6). BACKLIGHT Type: White
- 7). DIMENSIONS WITH MARK "*" ARE IMPORTANT
WITH MARK "()" ARE REFERENCED
- 8). All the raw materials are RoHS compliant

1	2	3	4	5	6	7	8	9	10	11	12	13	14
FLM	LP	CP	FR	V0	VCC	VSS	VOUT	D0	D1	D2	D3	DISP	OFF NC

REV	REVISION RECORD	DATE	 深圳市三元晶科技有限公司 ShenZhen TCC LCD Hi-Tech Co., Ltd.		MODEL NO.		SYMS0081CV10-5BFM4-B6N-315		GENERAL TOL: ± 0.3	
A0	First issue	04/15								
			APPROVED BY	CHECKED BY	DRAWING BY	PAGE?	OF	UNIT:	PROJECTION	
					LAN			mm		